

**pewag**



# Mounting Instructions

**pewag<sup>...</sup> traktor doppelspur**



# Quick Assembly

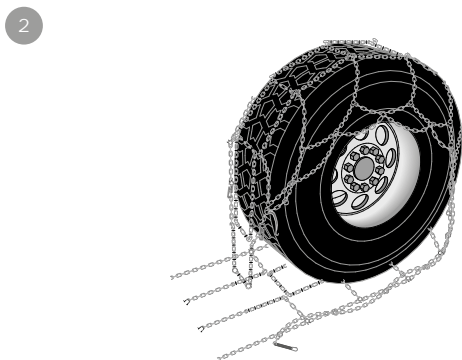
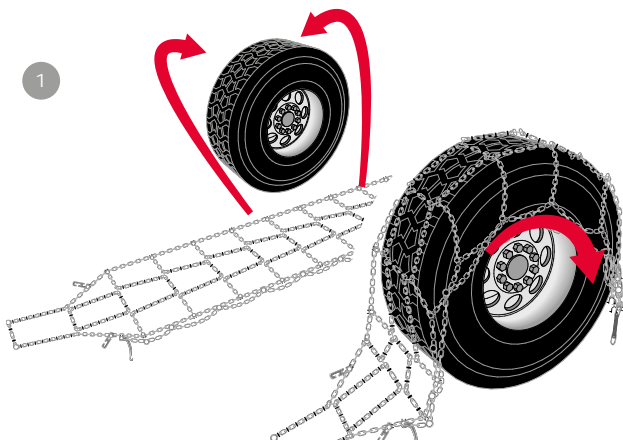

# Mounting

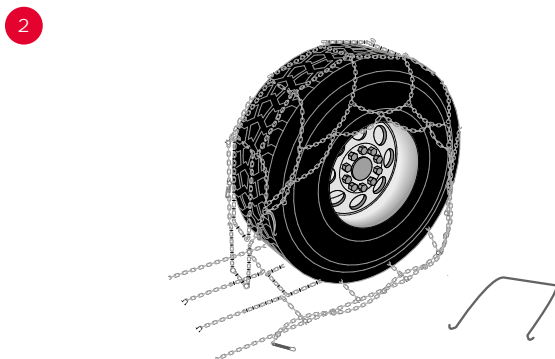
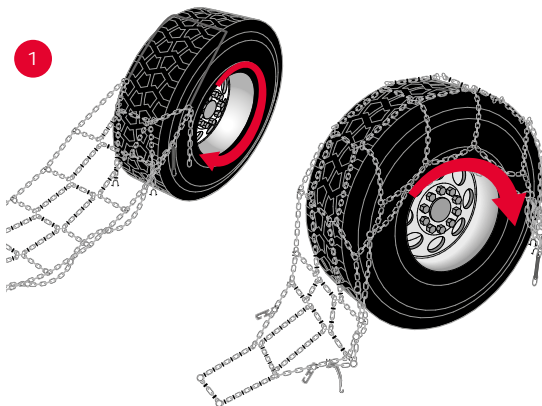

3

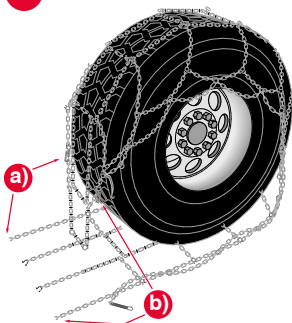

4

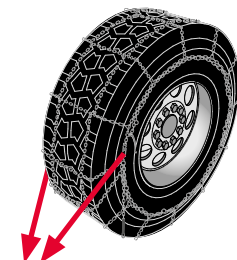

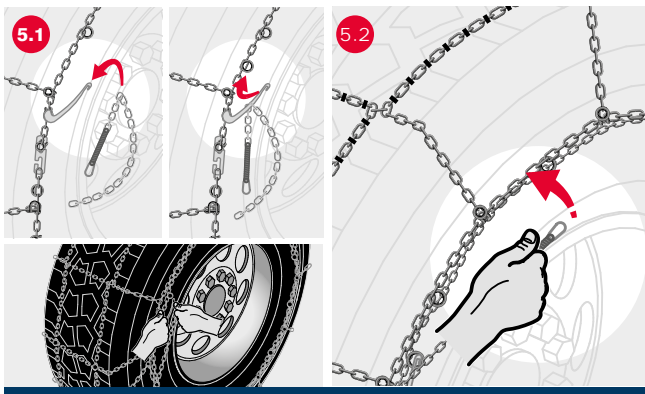

6



## Quick Assembly

- 1 Lift the chain up by the inner chain, pull backwards over the tire and distribute evenly to cover the whole tire.
- 2 Drive onto the chain by approx.  $\frac{1}{4}$  of a wheel's turn.

Complete the mounting process as outlined in points 3 to 6.

## Mounting

- 1 Spread out the anti-skid chains left or right of the tire tread and arrange them neatly (depending on the space, the chains may have to be bunched together). Tension lever and tension chain must face outwards! Place mounting cable at an angle across the top half of the tire. Hook anti-skid chain into mounting hook.
- 2 Drive slowly onto the chain to complete one full turn of the wheel. This will pull the chain onto the tire. Loosen the mounting hook of the mounting cable on the anti-skid chain. Remove the mounting cable.
- 3 Close side chain on the inside of the wheel - then on the outside. **Note:** Please ensure that the strands of the chain are not twisted!
- 4 Pull centre studs through the rings and secure them by hanging their ends into the side chains by means of the shackle.
- 5 Secure the loose chain end by hanging it into the side chain. Tighten tension chain on the outside of the wheel and insert tension lever into the next accessible link of the tension chain. Secure tension lever with the ring. Secure the loose chain end by hanging it into the side chain.
- 6 After driving a short distance (50 m or 150 ft.) stop the vehicle and re-check the tightness and fit of the traction chain on the tire. Re-tighten the chain if necessary.

# Demounting

- Unhook tightening spring.
- Open tightening lever and loosen tightening chain.
- Loosen closure hook (starting on the outside of the wheel).
- Open centre studs.
- Pull chain off of the wheel.

## Care instructions

Make sure that the chains are dried quickly after each use. Dirty chains should be rinsed in hot water and then dried. Badly rusted chains should be re-galvanised.

## Repair

**Regular inspection:** Turn the chains when one side of the links is worn down by 40 % of the wire diameter. **Exception:** Chains with welded-on grip links or stubs.

For repairs, please contact your retailer. Please refer to the vehicle manufacturer information and the enclosed instructions and warnings.

**pewag Schneeketten GmbH**

A-9371 Brückl, Kettenwerk 1

Phone: +43 (0) 50 50 11-0, Fax: +43 (0) 50 50 11-100

[schneeketten@pewag.com](mailto:schneeketten@pewag.com), [www.pewag.com](http://www.pewag.com)

